

KEYNOTES
 1 6" STEP IN BUILDING FOUNDATION

LEGEND

- EXISTING CONTOUR (5' INTERVAL)
- EXISTING CONTOUR (1' INTERVAL)
- PROPOSED GRADE
- EXISTING GRADE
- PROPOSED RETAINING WALL OR FOUNDATION FOR BUILDING
- CONCRETE PAVEMENT
- ADA PATH OF TRAVEL

ACRONYMS

- FF - FINISH FLOOR
- TW - TOP OF WALL
- BW - BOTTOM OF WALL
- FG - FINISH GRADE
- EG - EXISTING GRADE
- FL - FLOWLINE
- CN - CONCRETE
- AC - ASPHALT CONCRETE

EARTHWORK*

- 1,661 CY CUT
- 10,964 CY FILL
- 9,303 CY IMPORT

*EARTHWORK IS TO SUBGRADE

REV	DATE	DESCRIPTION

REVIEW ONLY, NOT FOR CONSTRUCTION

RSC ENGINEERING
 2250 Douglas Blvd, Suite 150
 Roseville, CA 95661
 Ph: 916.788.2884 Fax: 916.788.4408

PROJECT NO: 216-001
 DRAWN BY: RSC Eng
 CHECKED BY: RSC Eng
 DESIGNED BY: RSC Eng

INDUSTRIAL AVENUE SELF STORAGE
 8151 INDUSTRIAL AVENUE
 ROSEVILLE, CA 95678

SHEET TITLE
GRADING PLAN

SHEET NO.
GR1
 OF 7

CITY OF ROSEVILLE APPROVAL DATE: JANUARY 23, 2020

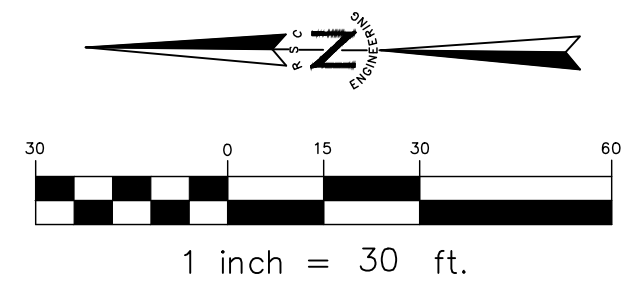
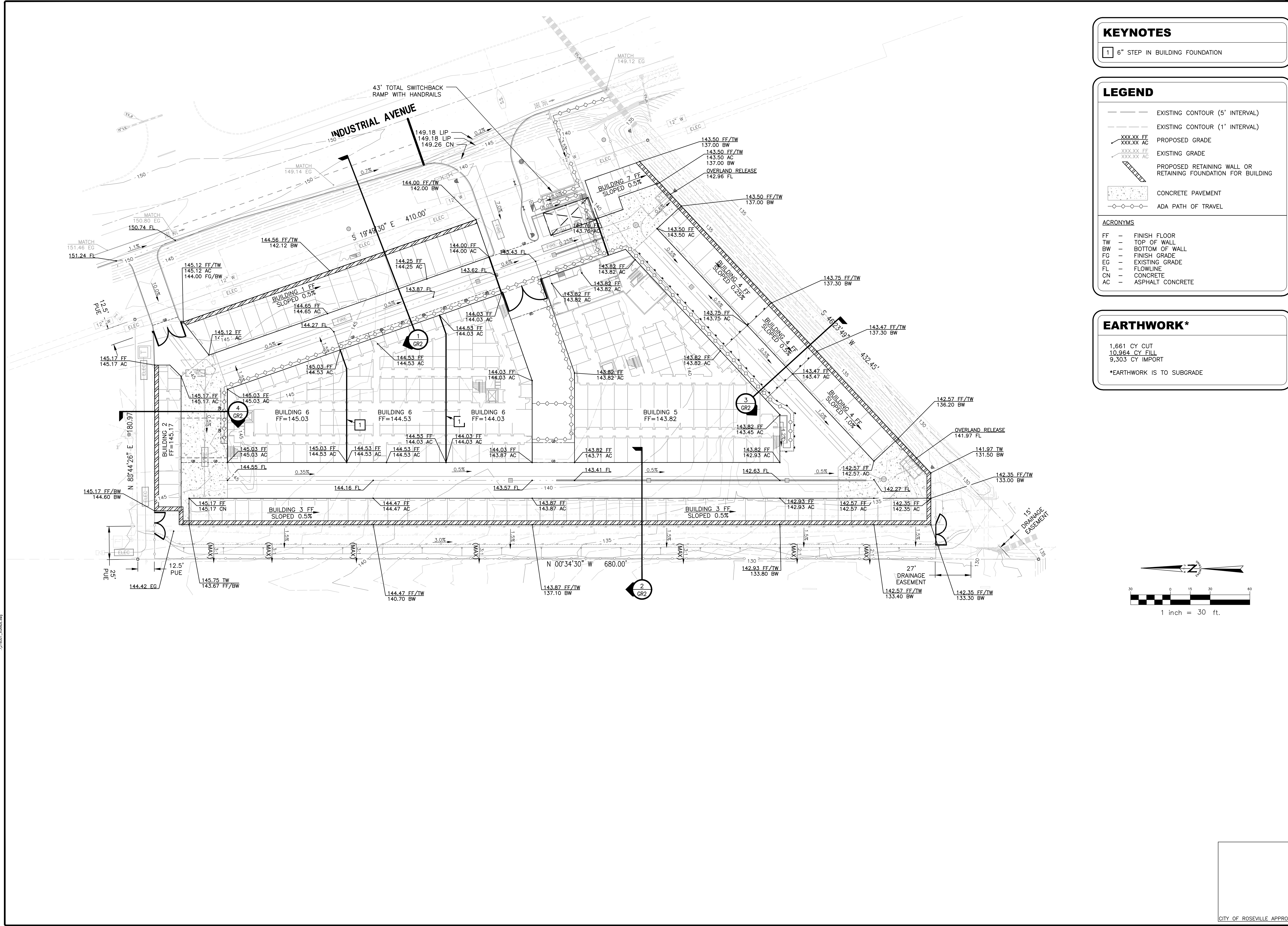

DRAWING: P:\216-001\City\Working\DWG\216001_G1.dwg
 USER: RSC001
 PLOT DATE: Jan 23, 2020 10:29 AM
 PLOT SCALE: 1"=30'

INDUSTRIAL AVENUE SELF STORAGE

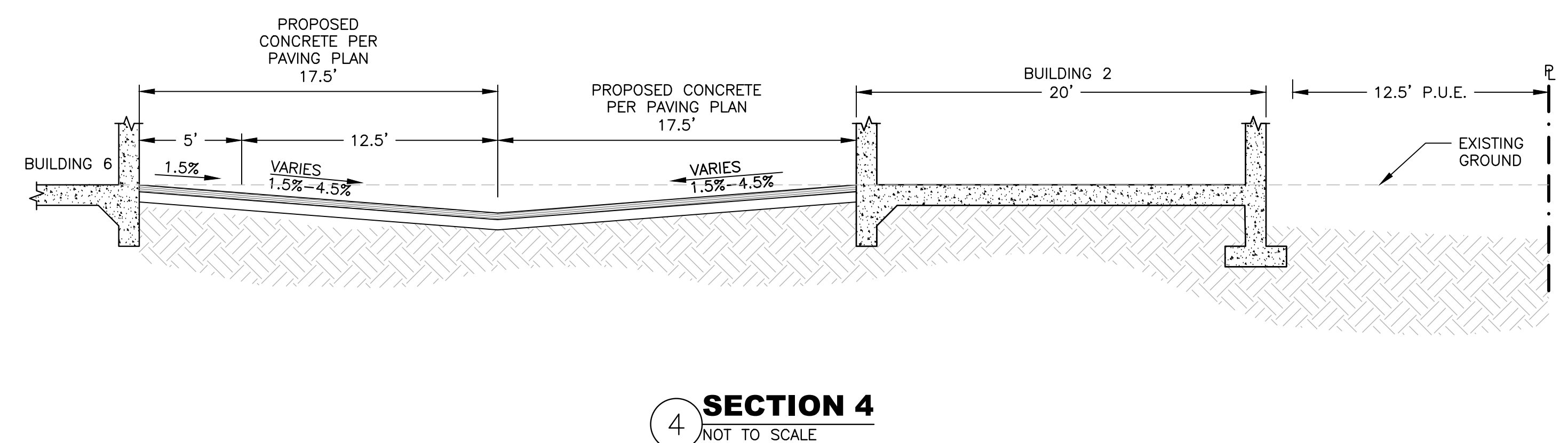
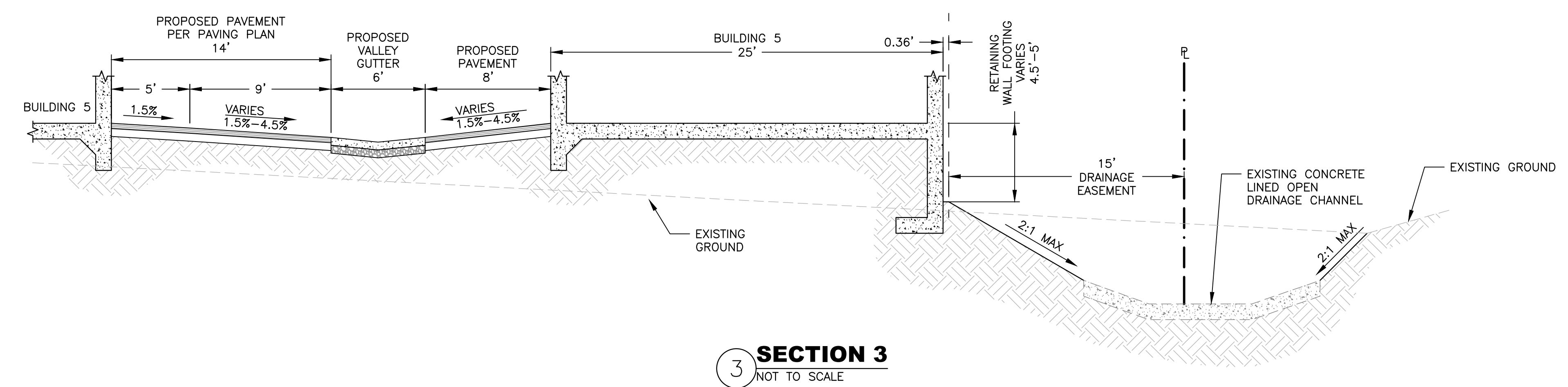
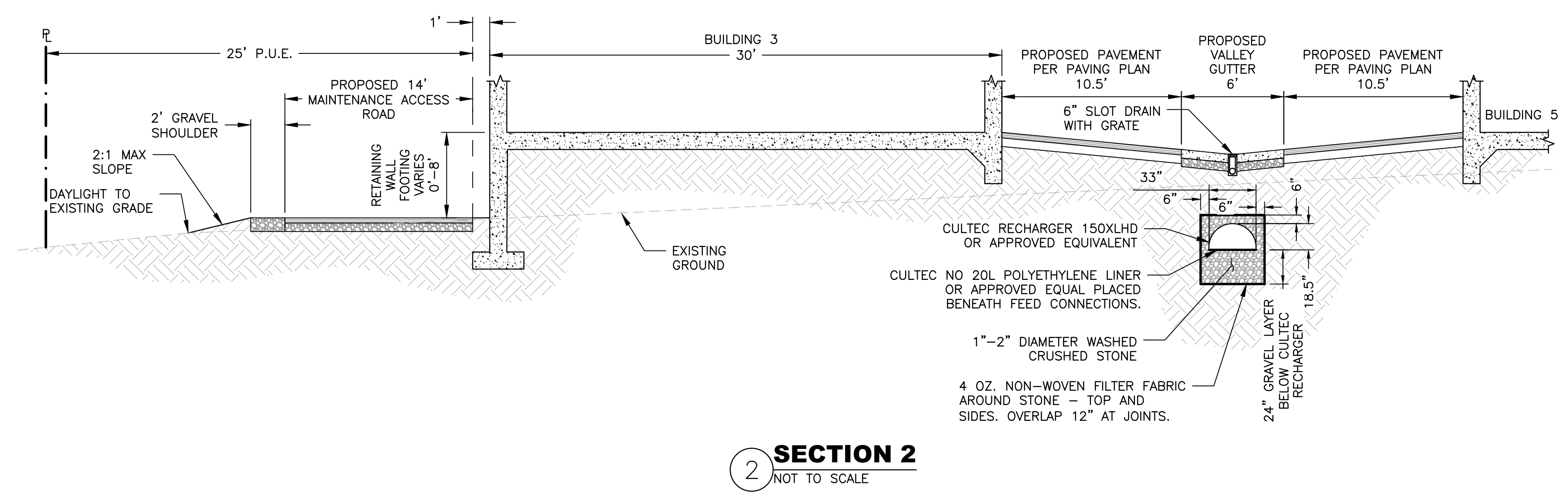
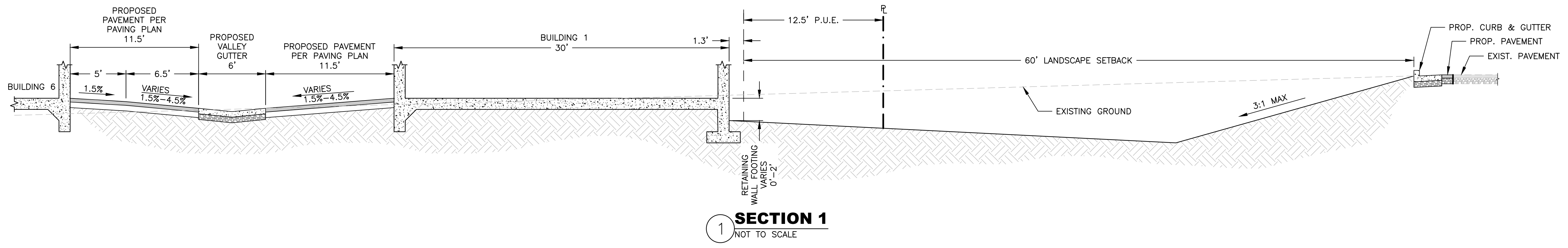

REV. NO.	DATE	DESCRIPTION



RSC ENGINEERING
2250 Douglas Blvd, Suite 150
Roseville, CA 95661
Ph: 916.788.2884 Fax: 916.788.4408

PROJECT NO: 216-001
DRAWN BY: RSC Eng
CHECKED BY: RSC Eng
DESIGNED BY: RSC Eng

INDUSTRIAL AVENUE SELF STORAGE
8151 INDUSTRIAL AVENUE
ROSEVILLE, CA 95678

SHEET TITLE
GRADING SECTIONS

SHEET NO.
GR2
OF 7

XREF: \316001_001.dwg
 WORKING FILE: \316001_001.dwg
 USER: JEFFREY
 PLOT DATE: Jan 23, 2020 10:54:46 AM
 DRAWING: P:\316-001\Cad\Working\DWG\316001_001.dwg
 USER: JEFFREY
 PLOT DATE: Jan 23, 2020 10:54:46 AM